

Trojan 110HD



Paradigm Trojan 110HD – pictured in action.

The new Trojan 110HD at 110" is the largest self-contained display in the world, (larger than even the Panasonic 103" plasma panel: 15% larger image area; 7% larger image width). Originally designed and manufactured for the UK Army, it is ideal for events, exhibitions – anywhere requiring large, bright, high resolution screens that can be transported and started quickly, easily and without skilled engineers.

The screen raises to working height (1.38m) using a cordless driver (drill) or the supplied handle. So there's no need for expensive extra lifting equipment! Trojans can be delivered and installed by two people. Standard units fit in standard high roof Mercedes Sprinter trucks.

Trojans are completely practical. All parts are replaced quickly and at reasonable cost. The most expensive component is the standard *projectiondesign* cineo30 projector (other Trojans use different projectors).

Trojan 110HD is the flagship in a range of units from 60" to 110" in 4:3 and 16:9 formats.

Options are available in different sizes, finishes, colours. Units can be ordered without the rugged flight case (to be fitted into other equipment or furniture).

- **Largest self-contained display in the world**
- **State-of-the-art optical rear projection technology**
- **Fits standard Mercedes Sprinter truck**
- **Transportable – wheel in & go in two minutes!**
- **Good looking & rugged**
- **Every part is replaceable – ideal for rental & events**
- **Uses standard projector for reliability & easy maintenance**
- **Buy or rent**
- **Available in image sizes up to 200" in both 4:3 and 16:9 formats**
- **Options for different finishes**

Paradigm Audio Visual Ltd

Swan Works, Box End Road, Bromham, Beds MK43 8LT UK.
Tel: +44(0)1234 843388 Fax: +44 (0)1234 854477
e-mail: info@rearpro.com website: www.rearpro.com

Paradigm Trojan HD110 Specifications

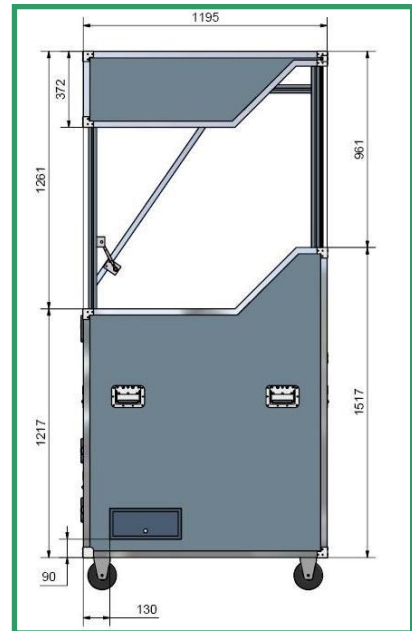
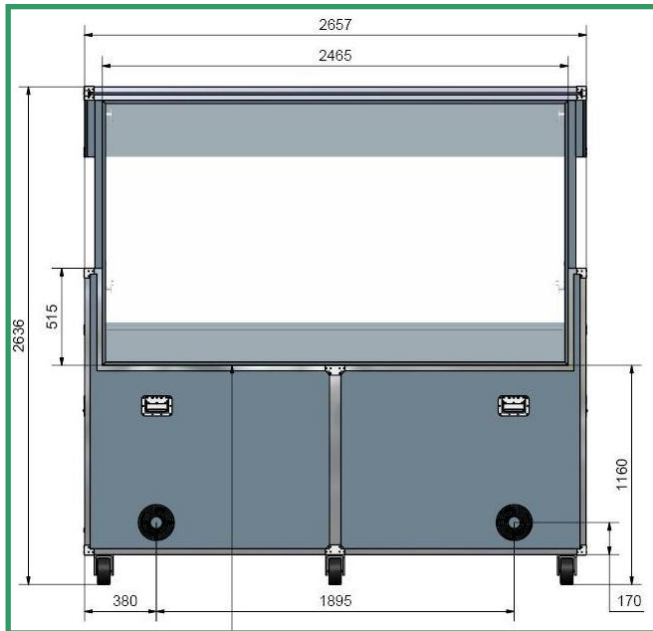

Product Code (Product/Type/Standard/Unpopulated)	Trojan/110HD/S/U
Dimensions (closed)	2657mm wide x 1746mm high x 1195mm deep
Dimensions (open)	2657mm wide x 2636mm high x 1195mm deep
Weight (approx)	185KG
Raising mechanism	Threaded "worm drive" using cordless driver (not supplied). Or use winding handle (supplied).
Finish	Rugged aluminium frame with infill panels, pale grey (many colours available)
Technology	Optical rear projection: Paradigm optical mirror path; dnp optical rearpro screen.
Image dimensions (width x height)	2432mm x 1368mm
Image area (m²)	3.33m ²
Image baseline	1375mm
Image luminance, up to	1110 nit [cd/m ²]
Image resolution (pixels)	1920 x 1080
Projector	projectiondesign cineo30 (see www.projectiondesign.com)
Projector lumens (ANSI)	4100
Projector contrast (on/off) - up to	7500:1
Computer input(s)	1x HDMI 1.3 (HDCP) with DPEq 1x DVI-D (HDCP) with DPEq
Video input(s)	2x RGBHV (5x BNC and 15-pin HDDSUB) 1x component video, 1x S-video, 1x video Optional HD/SD-SDI module
Audio input(s)	n/a
Control and communications	2x RS232 in/out (9-pin DSUB male/female) 1x TCP/IP (RJ-45) 1x USB
Power requirements	90 - 240 VAC, 50/60 Hz, +/- 10%, <1050W
Special options	Units are available with various projectors, in different sizes & finishes. Replay equipment (DVD, PC etc) & racks can be fitted. Units can also be supplied without the flight case exterior.
All specifications & dimensions subject to change without prior notice.	

Paradigm Audio Visual Ltd

Swan Works, Box End Road, Bromham, Beds MK43 8LT UK.
Tel: +44(0)1234 843388 Fax: +44 (0)1234 854477
e-mail: info@rearpro.com website: www.rearpro.com